

## Setting the Film Speed and Using the Meter.

### Set the Film Speed

To set the film speed, first push the film advance lever to its stand-off position away from the camera body, then lift up the ASA ring around the shutter dial and rotate it in either direction until the proper number is aligned with the green index mark.

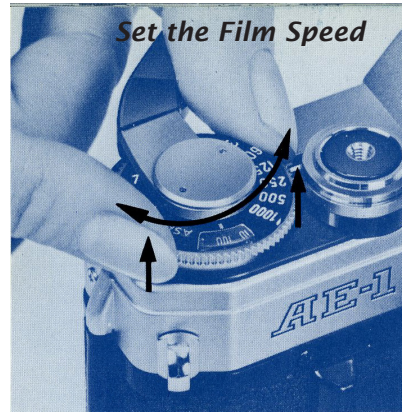

### Light Meter

First set the shutter speed to the desired setting. *TIP: For hand-held shots your shutter speed should be set to 125 or higher.* Then to use the light meter, lightly press the shutter release button while looking through the viewfinder. Make note of the aperture setting indicated by the meter needle in the viewfinder then set the aperture ring on the lens to the setting indicated. The setting will vary depending on your shutter speed and lighting conditions.

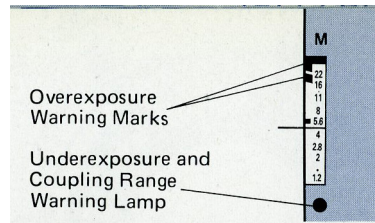

Meter

### Rewinding the Film

When the film advance lever cannot travel all the way to the end of its stroke, the film counter tells you that you have reached the end of the roll. You have to rewind the film into its protective cartridge before removing it from the camera. To rewind, press the small black rewind button on the bottom of the camera, unfold the rewind crank and turn it in the direction of the arrow. When the frame counter has reached the "S" mark you should stop. Then pull up the rewind crank and open the camera back.

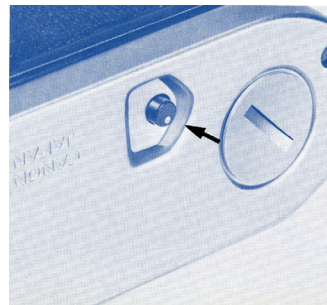

Rewind Button

# Getting started with the Canon AE-1

The Very Very Short Version.

### Check the Battery

Whenever you check out one of our cameras you should verify that the battery level is good.

The battery level is checked by pressing the battery check button on the top of the camera while watching the meter needle in the viewfinder. If the meter needle rests below the index mark or 5.6 the battery level is ok. If the meter needle rests above the index mark ask the lab aide to replace the battery for you.

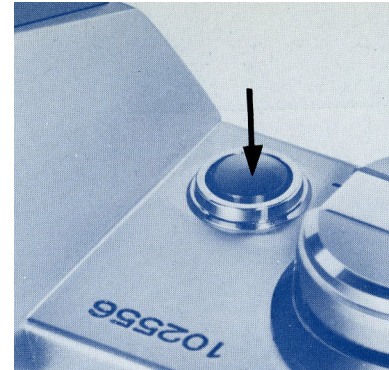

Battery check button

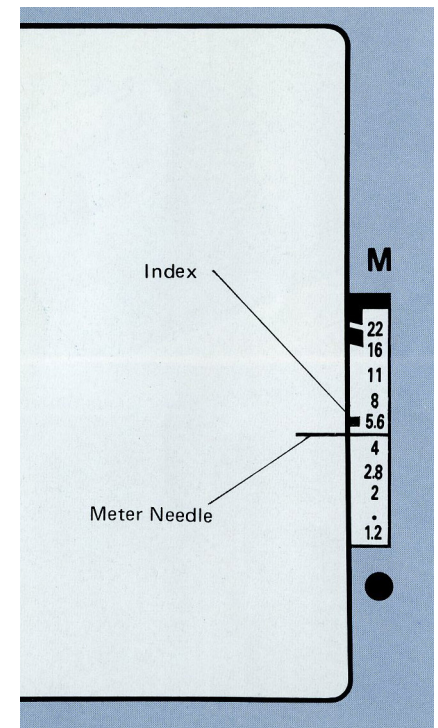

Meter needle as seen in viewfinder

## How to Load the Film

It is important to load the film correctly to avoid time consuming re-shoots. Follow these steps. Avoid direct sunlight when loading or unloading film.

### Open the Back Cover

Pull up the rewind crank and the back cover will pop open. The back cover can be securely closed by simply pressing it until it locks.

Next, Place the cartridge into the film cartridge chamber and press down while rotating the rewind knob until it drops securely into position. The protruding part of the cartridge should be on the bottom. Pull the film leader across and insert the end into one slot of the take-up spool. **Turn the film advance lever and wind the film around the take-up spool making sure that the perforations of the film are engaged in the teeth of the film transport sprocket.**

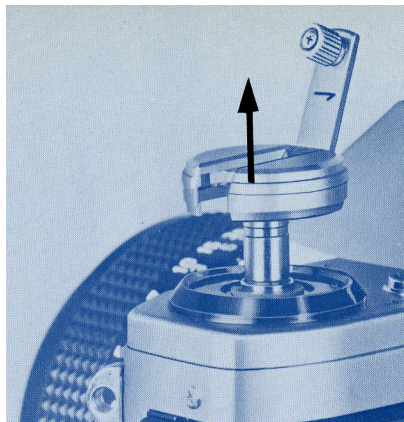

Rewind Crank

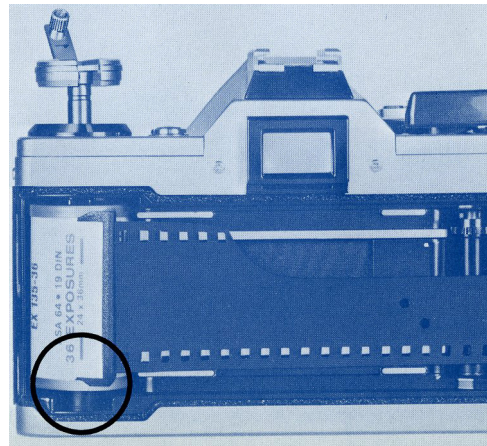

Film Cartridge Chamber

Then, make sure there is no film slack. In case there is, gently turn the film rewind crank in the direction of the arrow to obtain proper film tautness. Crank the film advance lever to ensure that the film leader is wound fully on to the take-up spool before closing the camera back.

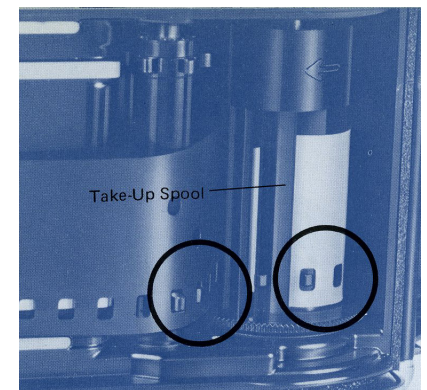
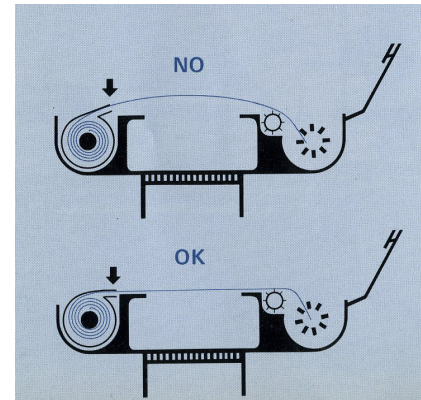

Take-Up Spool

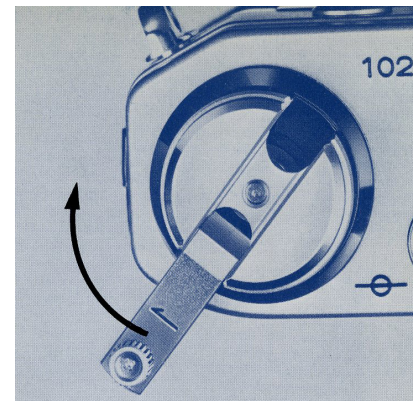

Rewind Crank

Close the back cover until it snaps shut. Gently turn the film rewind crank in the direction of the arrow to take up any remaining slack. Then, advance the film a couple of times pressing the shutter button until the first exposure appears in the frame counter. *TIP: Watch the film rewind knob as you advance the film. If it rotates, the film is properly loaded. If it doesn't, open the back cover and load the film again from the start.*